

Corrosion resistant and pressure washer protected with easy clean design

Hygienic and foodstuff-neutral due to smooth surfaces

Ergonomic multi-function tiller arm control head sealed to IP65

Strong performance with maintenance free 3rd Generation AC drive motor

Excellent travel stability during cornering with torsion bar suspension system "ProTraLink" made from stainless steel

Long life in demanding applications



EJE i20

Electric pedestrian pallet truck made from stainless steel (2000 kg)

The Jungheinrich stainless steel pallet truck EJE i20 combines the advantages of a stainless steel chassis with proven Jungheinrich drive and control technologies. The truck is designed for demanding operations up to 2000 kg.

The EJE i20 is suited for operation in corrosive and humid environments and satisfies the most stringent hygienic regulations. With these specifications, the truck is ideal for operations in the food, chemical and pharmaceutical industries.

High quality stainless steel offers abrasion resistant smooth surfaces that resist the

adherence of dirt and inhibit the spread of germs and bacteria.

The robust construction of the truck is designed for high pressure jet washing allowing easy cleaning and disinfection. Water can flow freely over the continuous bevelled surfaces, the special seals inhibiting the ingress of fluids into the drive and electronic control areas.

The newly developed multi-function tiller arm control head uses encapsulated sensor technology (IP65) that guarantees the highest reliability and resilience. Contactless electronic rocker switches as well as an easily

accessed crawl button allow for precise operation in every tiller arm position.

High acceleration, speed and efficient braking are the strengths of the drive motor, achievable by the application of innovative 3rd generation AC technology. The high cornering stability is achieved by the centrally driven EJE i20 by the use of the Jungheinrich "ProTraLink" torsion bar suspension made from high quality stainless steel. Side removal of the battery further ensures the efficient application of the truck in multi-shift operations. All of the above points add to the efficient, safe and fast handling of goods.

EJE i20

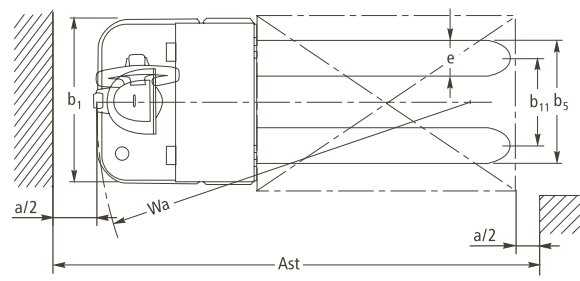
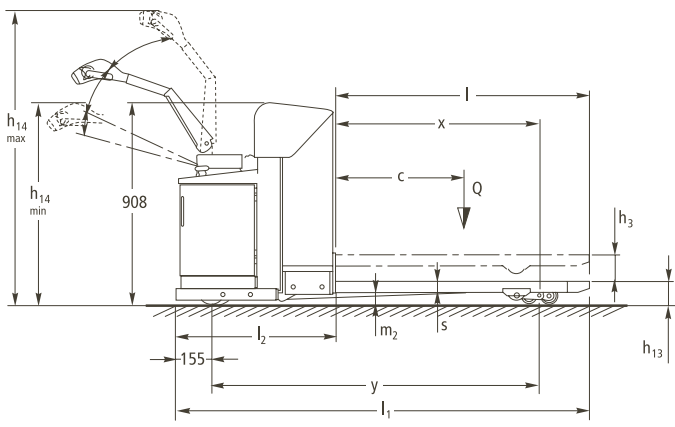

Technical data in line with VDI 2198 as at: 07/2008

Identification	1.1	Manufacturer (abbreviation)		Jungheinrich	1.1
	1.2	Manufacturer's type designation		EJE i20	1.2
	1.3	Drive		electric	1.3
	1.4	Operator type		pedestrian	1.4
	1.5	Load capacity/rated load	Q (t)	2	1.5
	1.6	Load centre distance	c (mm)	600	1.6
	1.8	Load distance, centre of drive axle to fork	x (mm)	835 ¹⁾	1.8
	1.9	Wheelbase	y (mm)	1364 ¹⁾	1.9
	Weights	2.1	Service weight incl. battery (see line 6.5)	kg	610
2.2		Axle loading, laden front/rear	kg	1044/4566	2.2
2.3		Axle loading, unladen front/rear	kg	470/140	2.3
Wheels, Chassis	3.1	Tyres		PU	3.1
	3.2	Tyre size, front	mm	230x65	3.2
	3.3	Tyre size, rear	mm	82x66	3.3
	3.4	Additional wheels (dimensions)	mm	125x54	3.4
	3.5	Wheels, number front rear (x = driven wheels)		3-1x/4	3.5
	3.6	Tread, front	b ₁₀ (mm)	467	3.6
	3.7	Tread, rear	b ₁₁ (mm)	390	3.7
Basic Dimensions	4.4	Lift	h ₃ (mm)	125	4.4
	4.9	Height of tiller in drive position min./max.	h ₁₄ (mm)	752/1423	4.9
	4.15	Height, lowered	h ₁₃ (mm)	85	4.15
	4.19	Overall length	l ₁ (mm)	1850	4.19
	4.20	Length to face of forks	l ₂ (mm)	711	4.20
	4.21	Overall width	b ₁ /b ₂ (mm)	740/–	4.21
	4.22	Fork dimensions	s/e/l (mm)	48/160/1150	4.22
	4.25	Distance between fork-arms	b ₅ (mm)	550	4.25
	4.32	Ground clearance, centre of wheelbase	m ₂ (mm)	40	4.32
	4.34	Aisle width for pallets 800 x 1200 lengthways	Ast (mm)	2250	4.34
	4.35	Turning radius	Wa (mm)	1685 ¹⁾	4.35
Performance Data	5.1	Travel speed, laden/unladen	km/h	5.3/5.3	5.1
	5.2	Lift speed, laden/unladen	m/s	0.046/0.06	5.2
	5.3	Lowering speed, laden/unladen	m/s	0.059/0.053	5.3
	5.7	Gradeability, laden/unladen	%	8/15	5.7
	5.10	Service brake		electric	5.10
Electric Engine	6.1	Drive motor rating S ₂ 60 min.	kW	1.6	6.1
	6.2	Lift motor rating at S ₃ 10 %	kW	2.2	6.2
	6.3	Battery acc. to DIN 43531/35/36 A, B, C, no		B	6.3
	6.4	Battery voltage, nominal capacity K ₅	V/Ah	24/230 ²⁾	6.4
	6.5	Battery weight	kg	230	6.5
Others	8.1	Type of drive control		AC SpeedControl	8.1

- 1) Load section raised: –84 mm
2) Rust proof material battery carrier

Make use of the advantages



Countersunk key switch and discharge display

"Hygienic design"

- Smooth corrosion free surfaces are food-stuff neutral resisting dirt and the spread of germs and bacteria.
- Stainless steel surfaces offer no risk of abrasion in production.
- Closed fork section ensures hygienic separation of the load wheels and the goods to be carried.
- Conforms to the EU directive for foodstuff hygiene.



Ready for battery change: open battery cover and removed side panel

Easy clean design

The whole truck is extremely easy to clean and is designed for daily operation in damp and wet areas:

- Bevelled surfaces allow water to flow over them with ease.
- Encapsulated multi-function tiller arm control head (IP65) with encapsulated contactless sensor technology safeguards against high pressure cleaning and disinfection.
- Robust seals protect drive and control components.
- Strong overlapping battery compartment hood protects the battery against the penetration of cleaning fluids.

High quality materials for demanding applications

The use of material suited to the application guarantees a high reliability and long life:

- Surfaces made from high quality stainless steel reliably prevent corrosion.
- Battery in plastic protective carrier, installed on slide rails.
- All controls are sealed and corrosion proof.

Ergonomic operation

The new generation multifunction tiller arm control head perfectly meets the ergonomic demands of the operator.

- Clearly laid out controls including buttons with countersunk/risen forms for intuitive control.
- An easy grip with close affinity to the hand posture of the operator.
- Crawl button on the underside of the tiller arm control head for easily reachable



Ergonomic tiller with contactless controls

operation with the tiller in the upright position.

- Rocker switches for comfortable operation in every tiller arm position.
- Centrally positioned large emergency stop button with safety guard.
- 3 color LED battery monitor informs at all times of the battery discharge status.
- Battery changing from above or side with plastic sliders (not battery rollers which easily corrode in adverse environments).



Excellent Service Access

Optimal cornering

The spring mounted and damped support wheels connected by the torsion bar suspension system "ProTraLink" made from stainless steel, ensure safe operation, a reduction in wear and high stability in every travel situation. Support is automatically distributed equally over all wheels during straight travel or concentrated on the outer support wheel during cornering.

Innovative 3rd Generation AC technology

Jungheinrich 3rd Generation AC technology motors offer high performance and at the same time, reduce operating costs:

- Powerful acceleration.
- Higher efficiency with excellent energy consumption.
- Faster travel direction change without delay.
- No carbon brushes – the drive motor is maintenance free.
- 2 year guarantee on the drive motor.

Jungheinrich UK Ltd.

Head Office:

Sherbourne House · Sherbourne Drive
Tilbrook · Milton Keynes MK7 8HX
Phone 01908 363100
Fax 01908 363180

info@jungheinrich.co.uk
www.jungheinrich.co.uk

Jungheinrich AG
ISO 9001, ISO 14001
Certification of Quality and
Environment Management.



Jungheinrich trucks
conform to the European
Safety Requirements.



JUNGHEINRICH
Well worthwhile